



INSTRUCTIONS FOR USE  
Pro-Ject A1

Dear Music Lover,

Congratulations and thank you for choosing Pro-Ject Audio Systems record player.

Your A1 turntable has been handcrafted and rigorously tested by skilled technicians to give you years of enjoyable, trouble free service.

Please contact your dealer if you require additional assistance.

**Important:**

Your turntable was shipped partially disassembled in order to avoid damage to sensitive parts. Please check immediately to make sure that neither the packaging nor the device was damaged in transit. If you are missing parts or if the unit is damaged, please do not operate and contact your dealer.

**Safety instructions**

*The power supply is used to connect and disconnect the unit from the mains. Make sure that the plug is easily accessible at all times. Hold the plug when unplugging the power cord. Never handle the power cord while your hands are wet or damp.*



*Avoid letting liquids enter the device. Never place any item containing liquid, like a flower vase, on or near the device. Never spill any liquid on the device. Never place any naked flame sources, like lighted candles, on or near the device. The product shall not be used in damp or wet locations, next to a bathtub, sink, swimming pool or any other similar conditions.*

*Keep plastic bags away from children to prevent any risk of suffocation.*

<u>General Information</u>	3
Controls, features and connections	3
In the packaging	3
<u>Setup</u>	
1. Unpacking and setup of the turntable	5
2. Connection to an amplifier or phono preamplifier	5
3. Starting and stopping record playback	5
4. Cartridge installation, stylus exchange	6
5. Maintenance and cleaning	7
<u>Technical specifications</u>	7
<u>Troubleshooting, warranty, service</u>	8

Please do your part to help protect the environment:

No immediate disposal of packaging material:

Pro-Ject packaging is carefully designed to protect your component from damage in transit and you are strongly urged to keep the original packaging in order to safely ship or otherwise transport your turntable in the future.

However, the packaging materials were chosen to be environmentally friendly, so if you must discard the packaging, please recycle.

# GENERAL INFORMATION

## Controls, features and connections

- 1 PLATTER
- 2 CHASSIS
- 3 FIXED COUNTERWEIGHT
- 4 TONEARM TUBE
- 5 HEADSHELL WITH FINGER LIFT AND PRE-MOUNTED ORTOFON CARTRIDGE
- 6 TONEARM REST / REMOVABLE TRANSPORT TWIST TIE
- 7 REPLAY SPEED LEVER
- 8 TONEARM LIFT LEVER
- 9 START/STOP LEVER
- 10 PHONO PREAMP ON/OFF SWITCH
- 11 DUSTCOVER HINGE HOLDERS
- 12 FELTMAT
- 13 RCA CABLE WITH EARTHING WIRE
- 14 POWER SUPPLY SOCKET

## In the packaging

- a TURNTABLE
- a.1/a.2 FIXED RCA CABLE (a.1) WITH EARTHING WIRE (a.2)
- b FELTMAT
- c DUSTCOVER
- d SINGLES ADAPTER
- e POWER SUPPLY
- f DUSTCOVER HINGES
- g PLATTER PROTECTION CARDBOARD
- h TONEARM TWIST TIE
- i STYLUS PROTECTION COVER
- j SETUP GUIDE AND TRANSLATION MATRIX (not pictured below)

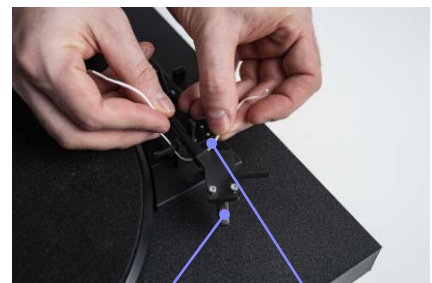

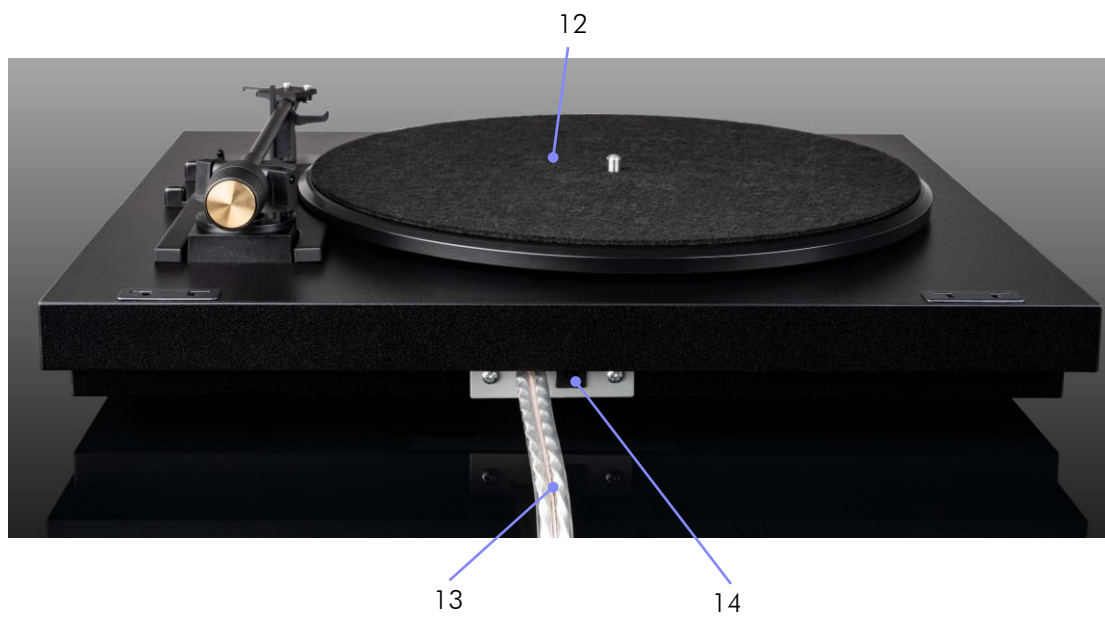
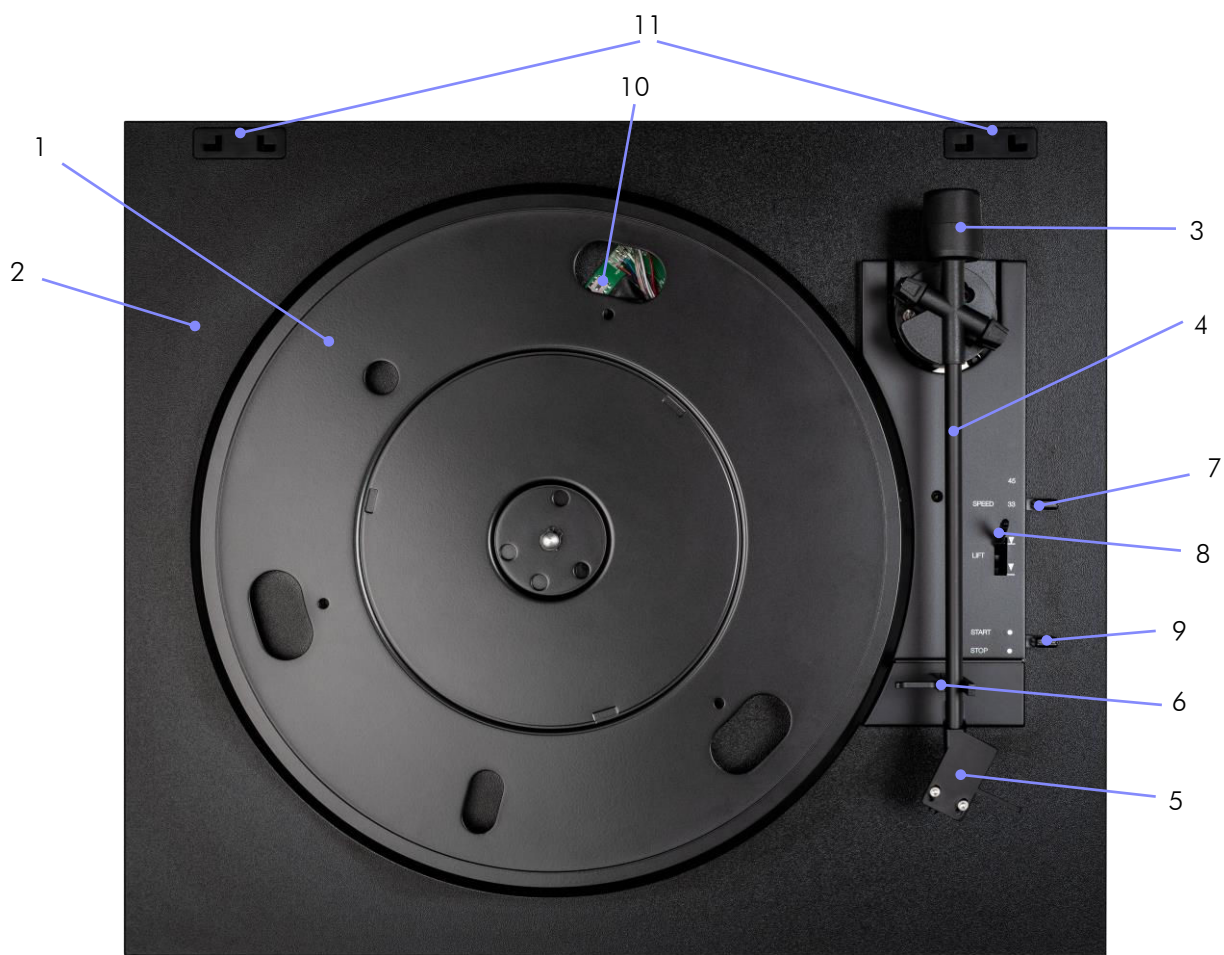

## SETUP



Please also refer to your Setup Guide (i) included in your A1 packaging for step by step instructions for unpacking your new A1, setting it up and playing your first record.

### 1. Unpacking and setup of the turntable

Unpack the turntable (a) and place it on a level surface. Remove the platter protection (g) and the tonearm twist tie (h). Install the dustcover hinges (f) in the dustcover (b) and slide it into the turntable hinge holders (11). Plug the power supply (e) first into the power socket on the turntable (14) and then into your mains power.

### 2. Connection to an amplifier or phono preamplifier

Your A1 turntable has a built-in phono-preamp (10). Manually move the platter (1), until the phono-preamp ON/OFF switch (10) is accessible. In the ON position, an external phono-preamp is not necessary, and the turntable can be connected to a regular line-in (such as AUX, CD, Tuner, Tape or Video) on your amplifier.

If you do however wish to use your external phono-preamp, the built-in phono-preamp can be switched OFF. In the OFF position connect your turntable to a suitable MM phono preamp or to a suitable MM phono input on your amplifier (sometimes labelled gram, disc or RIAA).

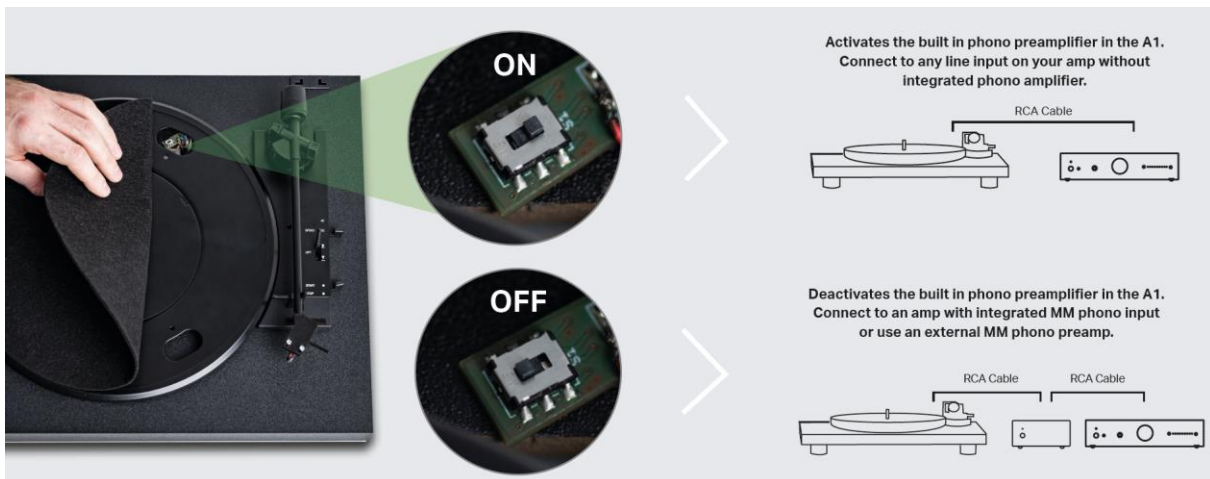

Take care to connect the left and right channels of your turntable's RCA cable (a.1) correctly. Right is marked red and left is marked white. On your amplifier, the right channel is usually marked red, the left channel black or white. Check the manual supplied with your amplifier for relevant information. The earthing wire (a.2) of the tonearm lead should be connected to the earth terminal on your amplifier or phono-preamp (if provided). If you use your turntable's built in phono-preamp, the earthing wire (a.2) does not need to be connected.

### 3. Starting and stopping record playback

#### Automatic start:

Put on a record and set your replay speed (7) to the RPM of your record. Most long play records need to be played with 33 RPM. Smaller 7" singles with 45 RPM. Also put the singles adapter (d) on the platter (1) spindle to play 7" singles. Remove the stylus protection cover (i). Move the lift lever (8) to the  $\nabla$  position. Push the START/STOP lever (9) to START to engage the automatics and start playing your record. The platter will start turning and the tonearm will automatically move to the correct start position and lower down to the record. When the record is finished the tonearm will be lifted and move back into its resting position automatically as well.





The start position is different between 33 and 45 RPM records. 45 RPM records are singles with a smaller 7" diameter. So the tonearm needs to move to a different position when playing those. Doublecheck your replay speed, in case your tonearm moves to the wrong position.



45 RPM records in 12" LP format or 10" single format must be started manually, as the automatics are preset for 7" singles. To do this, set the playback speed to 45 RPM and follow the **Manual start** instructions below.



### Manual start:

It is also possible to start playing records manually. To do this make sure the lift lever (8) is in the  position. Manually place the tonearm above the part of the record or song, from where you want to start playback. The platter will start spinning automatically as soon as you move the tonearm. Move the lift lever (8) to the  position to lower the tonearm onto the record. When the record is finished, the tonearm will move back into its resting position automatically.



Starting playback manually is recommended for advanced users or when you want to play only a certain song of a record or start playing the record further into it. Take care to not damage the stylus (needle) when doing so.

### Stopping playback:

Push the START/STOP lever (9) to STOP to stop playing the record at any time during playback. The tonearm will move back into its resting position automatically. Move the lift lever (8) back to the  position to ensure the tonearm rests in its lifted position. Playback can also be stopped manually at any time without affecting the function of the automatics system. Move the lift lever (8) to the  position to stop playback at the desired point and then return the tone arm manually to the tone arm holder.

## 4. Cartridge installation, stylus exchange

Your A1 turntable comes with a cartridge which has already been factory aligned and is ready for playback immediately.

For advanced users, in case you want to switch cartridges, install your new cartridge into the headshell, using the appropriate hardware included with your new cartridge. All cartridges with half inch mounting holes can be fitted.

Connect the cartridge as indicated below:

- White                    left channel L+
- Red                      right channel R+
- Green                  right channel R-
- Blue                     left channel L-

For correct cartridge alignment, use a cartridge alignment protractor of your choice (not included with your A1 turntable). If unfamiliar with this setup, please refer to your dealer.

A damaged or worn stylus may harm your record collection and should be replaced.

Please remove the stylus protection before pulling the stylus from the cartridge and replace for a new one. Exchange stylus for the pre-mounted cartridge Ortofon OM10: Stylus OM10. If in doubt, consult your local dealer or distributor.

## 5. Maintenance and cleaning

Your record player requires little or no regular maintenance. Remove dust with a slightly moistened antistatic cloth. Never use a dry cloth because this will create static electricity which attract more dust! Antistatic cleaning fluids are available at specialist stores but must be applied sparingly to avoid damage to rubber parts. It is recommended to fit the needle cover (i) before cleaning or maintenance is carried out to avoid damage.



*Always disconnect the record player from the mains power supply as a precaution before maintenance!*

### Technical specifications Pro-Ject A1

Nominal speeds	33/45 RPM
Speed variance	33: $\pm 0.75\%$ 45: $\pm 0.65\%$
Wow and flutter	33: $\pm 0.27\%$ 45: $\pm 0.25\%$
Signal to noise	-65dB
Effective tonearm mass	ULM (ultra light mass) design principle
Effective tonearm length	8.3" (211 mm)
Overhang	19,5mm
Power consumption	1,5W
Outboard power supply	15V/800mA DC, suitable for your country's mains supply
Dimensions (W x H x D)	430 x 130 x 365mm
Weight	5,6 kg

### Technical specifications MM-Cartridge Ortofon OM10

Frequency range	20-22.000Hz
Channel separation	22dB/1kHz
Output voltage	4mV
Recommended load impedance	47kohms/amplifier connection – MM-input
Compliance/stylus type	25 $\mu$ m/mN – elliptical
Recommended tracking force	15mN
Weight	5g

### Technical specifications MM phono pre-amplifier

Gain	34dB
Output voltage typically	200mV/1kHz at 5mV/1kHz input
Input impedance	47kohms/100pF
Noise floor	-68dB
RIAA-equalisation curve accuracy	20Hz-20kHz / max. 0,5dB

## Potential incorrect use and fault conditions

Pro-Ject turntables are manufactured to the highest standards and undergo strict quality controls before leaving the factory. Faults that may possibly occur are not necessarily due to material or production faults but can sometimes be caused by incorrect use or unfortunate circumstances. Therefore, the following list of common fault symptoms is included.

### The platter doesn't turn although the unit is switched on:

- The unit is not connected to the mains power supply.
- No mains at the socket.
- Drive belt is not fitted or has slipped off.

### No signal through one or other channel or both channels:

- No signal contact from the cartridge to the internal tonearm wiring or from that to the arm lead or from that to the phono box or between that and the amplifier. This could be due to a faulty plug, broken wire or solder joint or simply loose plug/socket connection.
- Phono input not selected at amplifier.
- Amplifier is not switched on.
- Amplifier or speakers are defective or muted.
- No connection to the loudspeakers.

### Strong hum on phono input:

- No earth connection from cartridge or arm or arm cable to amplifier, or earth loop.

### Distorted or inconsistent sound from one or both channels:

- Record player is connected to wrong input of amplifier, or MM/MC switch incorrectly set.
- Needle or cantilever damaged.
- Wrong RPM., drive belt overstretched or dirty, platter bearing without oil, dirty or damaged

## Service

Should you encounter a problem which you are not able to alleviate or identify despite the above information, please contact your dealer for further advice. Only when the problem cannot be resolved there should the unit be sent to the responsible distributor in your country.

Guarantee repairs will only be affected if the unit is returned correctly packaged. For this reason we recommend keeping the original packaging.

Never return a record player without making sure that it is safely disassembled and correctly packaged in the original packaging according to the diagrams on the last page of this user guide. Please remove these parts and pack them separately: lid, counterweight, anti-skating weight and belt.

Fit the cartridge protection cap and the transport lock for the tonearm tube, prior to carefully packaging the record player.

## Warranty



*The manufacturer accepts no responsibility for damage caused by not adhering to these instructions for use and/or by transportation without the original packaging. Modification or change to any part of the product by unauthorized persons, release the manufacturer from any liability over and above the lawful rights of the customer.*

Pro-Ject Audio Systems is a Registered Trademark of H. Lichtenegger.

This guide was produced by: Pro-Ject Audio Systems  
Copyright © 2022. All rights reserved.

The information was correct at the time of going to press. The manufacturer reserves the right to make changes to the technical specification without prior notice as deemed necessary to uphold the ongoing process of technical development.



